

# Preface

Dear owners,

Thank you very much for using our products. Please carefully read this manual before first-time use so that you can know about the operation method for the product, which facilitates you to safely use and better enjoy entertainment! Please read this manual carefully before using the services. You can call the Riddara customer service hotline if you have any questions.

Some functions of this model require traffic services; using related applications may require purchasing products or services, please purchase voluntarily as needed. For details, please consult your local authorized dealer or service centre based on the actual vehicle condition.

Important security information:

- In order to avoid the violation of traffic rules, and any unwanted traffic accident, the driver is prohibited to watch any program and operate this device during driving.
- Due to the mutual interference between the audio amplifier and the phone, echo and sound distortion may occur in the vehicle. Therefore, in the vehicle, do not use your phone to make or receive a call from any in-vehicle person via the Bluetooth function.
- To ensure safe and normal use, do not disassemble or repair the infotainment head unit by yourself to avoid damage to the unit or accidents.

Due to the continuous upgrading of the product, the actual operation steps may not fully comply with the manual. Please use the manual according to the actual operations.

The working voltage of the product is 9V ~ 16V. In the case that the low-voltage battery is not replaced in time according to the maintenance manual, the battery will lose power and cause insufficient power supply, which may lead to product self-protection and restart.

If you have the following behaviours, we may suspend the relevant services for you:

- Violations of Chinese laws and regulations;
- Provision of false registration information;
- Use of services by improper means;
- Acts that harm other users; Abuse of user rights;
- Violations of social customs and morals;

- Acts that incite ethnic hatred, ethnic discrimination, and undermine national unity;
- Dissemination of obscene, pornographic, gambling, violent, homicide, terror information or instigation of crimes;
- Acts that undermine national security, leak state secrets, subvert state power, and undermine national unity.

If you have any questions, please contact us:

- Riddara customer service hotline: 400-111-8264;
- Mail letters to: No. 99 Meishan Road, Xi Tan Community, Zichuan Economic Development Zone, Zibo City, Shandong Province;
- Our website: <https://www.radar-ev.com/>

Shandong Tangjun Ouling Automobile Manufacture co., Ltd.  
August 2025, Version 1

©Shandong Tangjun Ouling Automobile Manufacture co., Ltd.

Without the written permission of Shandong Tangjun Ouling Automobile Manufacture co., Ltd., this manual cannot be reproduced or copied in whole or in part.



# Contents

## Description

- 3 Safety Information
- 3 Notice to owners

## Multimedia system (Type 1)

- 5 System overview
  - 5 System introduction
  - 5 System desktop
  - 7 System power on and screen off
- 7 My car
  - 7 My car
  - 7 Sound
  - 8 Assistant
  - 8 Others
  - 8 System
- 9 Status bar
  - 9 Bluetooth
  - 9 WLAN
  - 10 On-board hotspot
- 10 Voice
  - 10 Introduction
  - 10 Common voice interactions
  - 11 Voice assistant
- 12 Multimedia
  - 12 Introduction
- 12 CarbitLink

- 12 CarbitLink
- 13 Phone
  - 13 Making calls
  - 13 Answering and ending calls
- 13 Theme
  - 13 Theme
- 14 Around view monitor (AVM)
  - 14 Around view monitor (AVM)

## Multimedia system (Type 2)

- 15 System overview
  - 15 System introduction
  - 15 System desktop
  - 17 Power On/Off and Restart
- 17 Vehicle setup
  - 17 Set up
  - 17 Vehicle
  - 19 Connect
  - 19 Sound
  - 19 Display
- 20 Multimedia
  - 20 Introduction
- 21 Phone
  - 21 Making calls

1

2

3

4

5

6

7

8

9

---

21	Answering and ending calls	23	EasyConnection
		23	EasyConnection
22	Video and Photo	23	Rear view camera (RVC)
22	Video	23	Introduction
22	Photo		



## Safety Information

- There is an uninsulated dangerous voltage in the product shell, which may cause the risk of electric shock to personnel.
- To reduce the risk of electric shock, do not remove the shell or back cover of the product without authorization. If a malfunction occurs, please contact professional maintenance personnel.
- To reduce the risk of fire and electric shock, do not expose this product to humidity such as high moisture or rain.
- Always safely control the vehicle. Do not divert your attention while driving and always pay attention to the driving situation. First confirm the safety and legality of the operation before changing the settings or any other function options. To ensure safety, some functions will be restricted during driving until the vehicle comes to a complete stop.
- When driving, make sure that the sound volume inside the vehicle will not affect your ability to hear external sounds.
- Handle with care, no heavy objects can be stacked on this product.
- When driving, the driver shall not watch the display. Otherwise, it may cause fatal accidents due to distraction.

## Notice to owners

- Do not use your phone while driving. You must park in a safe place when you need to use your phone.
- Multimedia operating temperature: -30°C to 75°C, storage temperature: -40°C to 85°C.
- The judgment of a cell phone navigation system is not completely accurate. Drivers still need to make assessments based on actual conditions, obey traffic rules and constantly pay attention to current traffic situations.
- In case of discrepancies, traffic laws and the current traffic situation always take precedence over the mobile navigation system.
- For safety concerns, you can only use the navigation system menu before starting to depart or when the vehicle is stationary.
- In places where there is only one road, if the road breaks or is prohibited from access (e.g., pedestrian streets), the navigation system will issue a warning. Take care in such situations.
- The navigation system does not take route safety into account when suggesting routes. Issues that could affect driving route safety and time, such as obstacles, building locations, height and weight restrictions, traffic and weather conditions are not taken into consideration in the suggested routes. It is up to the

## Description

---

driver to decide which route is the most suitable.

- The speed limits specified in current road traffic laws are more authoritative than the stored data in the navigation system. The navigation system cannot always align with traffic laws on speed limits in any situation. The driver should always be aware of the speed limits set by current road traffic laws and drive safely.
- Do not rely solely on the navigation system to locate emergency services (such as hospitals, fire facilities, etc.). The system may not contain data on all emergency services in the vicinity in the database. It is up to the driver to find emergency help on his or her judgment.



Do not disassemble or modify this product. Failure to do so may result in accidents, fires, and electrocution. In case of a breakdown, please contact an authorised service centre on time. While driving, the driver should not watch videos.

## System overview

### System introduction

The in-vehicle infotainment system mainly consists of components such as multimedia, software applications, loudspeakers (bass, tweeter), microphone, POWER button, buttons on the right side of the steering wheel, USB port and Type-C port.

It mainly achieves functions such as USB audio and video playback, time display, Bluetooth phone calls, information display, voice control function, air conditioning information display and settings.

## System desktop

### Introduction

The system desktop mainly displays content such as virtual images and intelligent scene recommendations. The homepage provides a variety of widgets (application widgets), such as AVM, Multimedia and Apple CarPlay. Tap the icon near the vehicle model on the system desktop to quickly access the energy management screen.

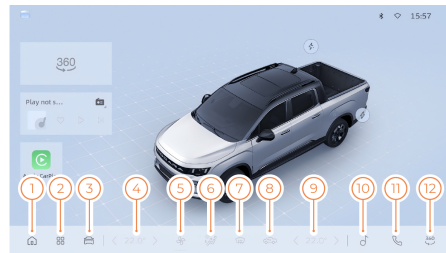

1. Tap the button to access the main interface of the multimedia screen.
2. Tap the button to open the APP list.
3. Tap the button to open the My car.
4. Tap </> to decrease/increase the driver's side air conditioning temperature. Tap the temperature display area to open the climate control interface. Press and hold the button to quickly adjust the driver's side air conditioning temperature.
5. Tap the button to open the climate control interface. When the air conditioning is on, press and hold the same button to turn it off.
6. Tap the button to adjust the air vent mode. Press and hold to bring

up a quick control list where you can replace this button with another button.

7. Tap the button to turn the front window defrost/demist function on or off. Press and hold to bring up a quick control list where you can replace this button with another button.
8. Tap the button to switch air recirculation/fresh air mode. Press and hold to bring up a quick control list where you can replace this button with another button.
9. Tap  $\lt/\gt$  to decrease/increase the front passenger's side air conditioning temperature. Tap the temperature display area to open the climate control interface. Press and hold the button to quickly adjust the front passenger's side air conditioning temperature.
10. Tap the button to open the Multimedia APP. Press and hold to display the app list and replace this button with another app icon.
11. Tap the button to open the Phone APP. Press and hold to display the app list and replace this button with another app icon.
12. Tap the button to open the AVM APP. Press and hold to view the app list and replace this button with another app icon.

The APP list screen contains a variety of APPs, such as Multimedia, Phone and Theme, to cater for most of the scenarios during the use of your vehicle. We are continuously improving

the system and will gradually introduce more useful APPs.

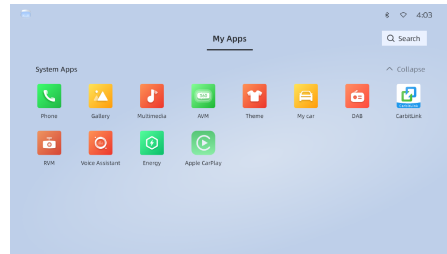

## Introduction to the drop-down menu bar

Slide down from the top to drag out the control centre, and by clicking the Edit button in the upper right corner you can add, subtract or move the soft switches of the control centre.

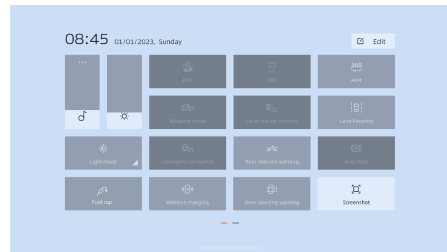

## System power on and screen off

### Power on

When the system is turned off, you can turn it on using any of the following methods:

- Press the start switch once when the brake pedal is not depressed, and the start switch switches to the ACC position.
- Press the start switch twice when the brake pedal is not depressed, and the start switch switches to the ON position.
- Depress the brake pedal and press the start switch to start the vehicle.

### Screen off

After the screen is turned off, click on any location on the desktop to unlock the screen again.

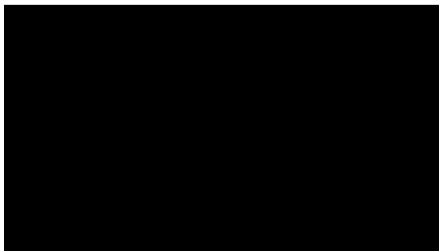

## My car

### My car

Tap the My car APP icon to enter the My car screen.

The screen contains options such as Driving, Controls, Smart Lock, Assistance, Energy, Lighting, Sound, and Assistant, covering common vehicle settings as well as safety and security settings, which can provide you with a better driving experience.

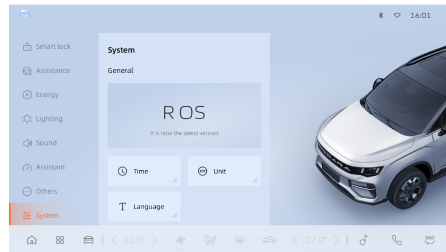

## Sound

Go to My car → Sound.

You can set sounds for the entire vehicle.

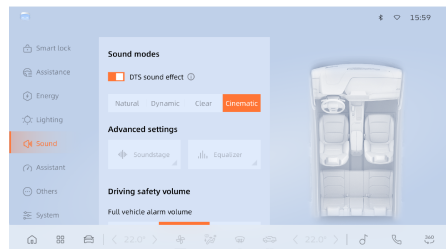

[Full vehicle alarm volume]: You can set the volume to Low, Medium or High.

## Multimedia system (Type 1)

[Volume adjusts with vehicle speed]:

You can set the volume to Close, Low, Medium or High.

[Touch sound]: You can set the touch sound.

[Low-speed driving sound effect]: You can set the sound effect.

## Assistant

Go to My car → Assistant.

You can set Head unit management, Smart mode and Vehicle and service information.

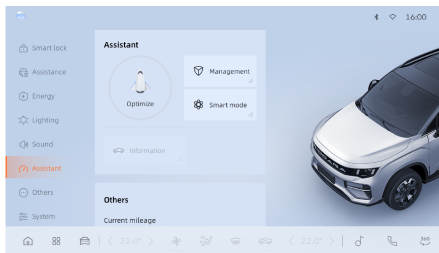

## Others

Go to My car → Others.

You can set the current mileage, subtotal clearing and system gestures.

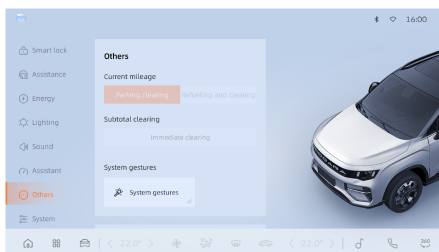

## System gestures

Go to My car → Others → System gestures.

You can set the one-finger, two-finger and three-or more-finger gestures.

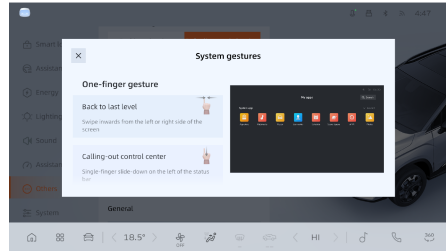

## System

Go to My car → System.

You can configure General, App management, and Reset.

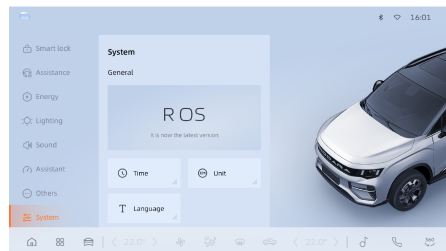

## General

Go to My car → System → General.

You can view the system version and set the time, unit and language.

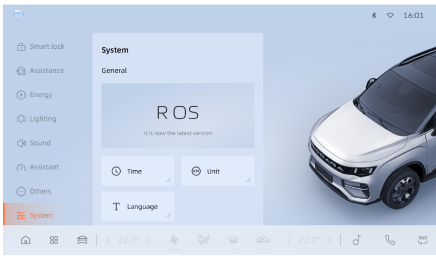

## App management

Go to My car → System → App management.

You can set Authority, Storage and Security.

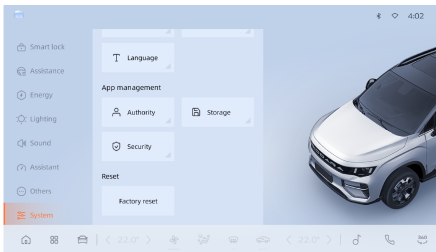

## Reset

Go to My car → System → Reset.

You can factory reset the head unit.

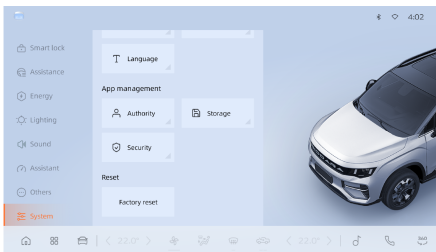

## Status bar

### Bluetooth

Tap Status bar → Bluetooth on the multimedia display.

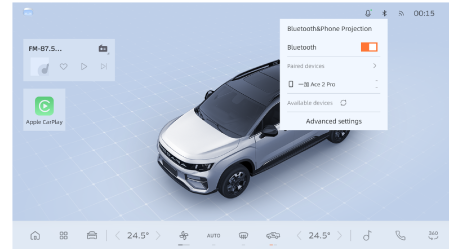

You can turn the Bluetooth on or off.

Turn on the Bluetooth, search for Bluetooth devices, and at the same time turn on the Bluetooth on your phone, select your mobile Bluetooth for pairing and your phone will receive a message alert for pairing.

### WLAN

Tap Status bar → WLAN on the multimedia display.

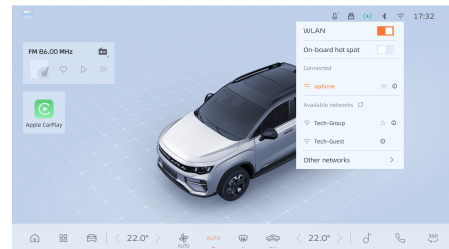

You can turn on and off the WLAN.

After turning on the WLAN, select the corresponding WLAN network to connect to it.

### On-board hotspot

Tap Status bar → WLAN → On-board hotspot on the multimedia display.



You can control the on-board hotspot on/off. After turning on the hotspot, you can find the network on your phone and connect your phone to it. You can also customize the hotspot name and password.

## Voice

### Introduction

Voice is a more appropriate and convenient way of interaction in the vehicle. We expect to free your hands through voice interaction and provide you with a more intelligent, scenario-based and humanized experience. The voice assistant can help you use the system applications better.

### Common voice interactions

#### Voice wake-up

- Briefly press the voice button on the steering wheel to wake up the voice assistant.
- Tap the voice assistant app on the desktop.
- Wake words: "Hi Riddara".

#### Voice calling

After waking up the assistant, the system is connected to Bluetooth and you can make a call by voice command.

More features are waiting for you to discover.



## Voice assistant

Voice Assistant allows configuration of Wake-up word, Voice response sound, Delayed listening, and Sound source localization.

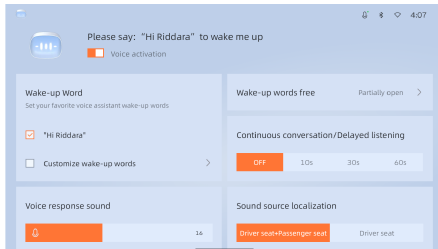

### Multimedia

#### Introduction

Multimedia includes Bluetooth music and USB music for easy access.

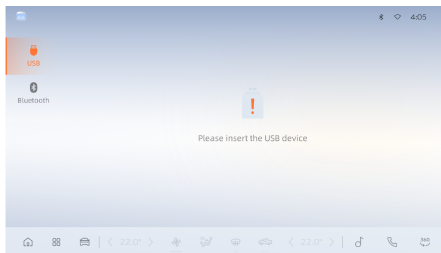

### CarbitLink

#### CarbitLink

Tap the CarbitLink APP icon to enter Phone Interconnection.



## Phone

### Making calls

Multiple ways to make calls are offered.

1. Dial. Enter the number you want to call in the phone number field of dial pad.

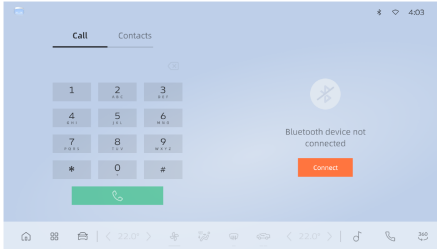

2. Contacts. Select a number from Contacts.

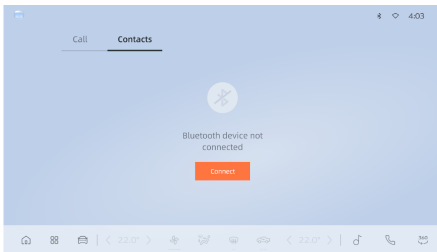

### Answering and ending calls

You can answer and end calls via the dedicated buttons on the steering wheel, or using the touchscreen.

## Theme

### Theme

Click the theme app icon to enter the mall homepage.

You can choose a new wallpaper for the centre console display or instrument cluster display on the mall homepage. After selecting your favourite wallpaper and downloading it, you can apply it to replace the centre console display or instrument cluster display wallpaper.

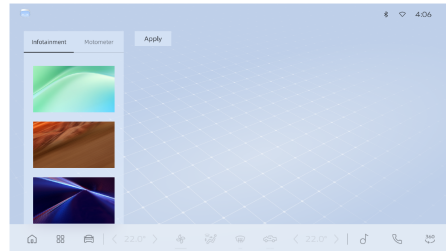

## Around view monitor (AVM)

### Around view monitor (AVM)

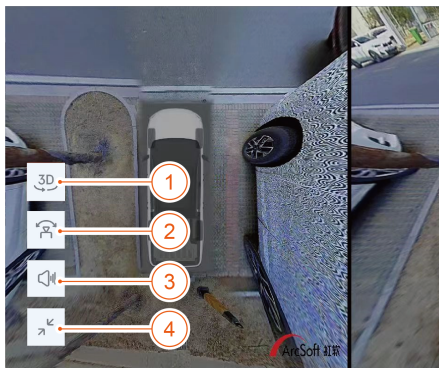

The panoramic view interface can be accessed directly by tapping the AVM app icon or shifting the gear into R. The driver can switch the panoramic view by tapping the corresponding button on the multimedia display.

1. 2D/3D switch button  
It can switch between 2D and 3D view effects, and supports touching and sliding in the 3D image area to change the viewing angle of the 3D view.
2. View button  
Click to expand the 4 views switching modes.
3. Radar warning volume adjustment button  
Enable or disable the radar warning volume.
4. Unfold/Fold button  
Unfold/fold the function.

## System overview

### System introduction

The in-vehicle infotainment system mainly consists of components such as multimedia, software applications, loudspeakers (bass, tweeter), microphone, POWER button, buttons on the right side of the steering wheel, USB port and Type-C port.

It mainly achieves functions such as USB audio and video playback, time display, Bluetooth phone calls, information display, air conditioning information display and vehicle settings.

## System desktop

### Introduction

The desktop widgets include Multimedia, EasyConnection and Telephone.

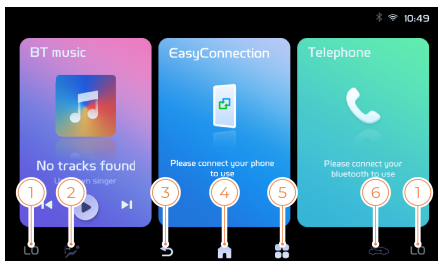

If the A/C settings menu is closed, you can use the toolbar buttons below for quick control:

1. Tap to open the A/C settings menu.  
If the A/C menu is closed, the

button area shows the current air conditioning temperature.

2. Tap to open the A/C settings menu.  
If the A/C menu is closed, the button area shows the current air vent mode.
3. Tap to return to the previous level.
4. Tap to open the home screen.
5. Tap to open the applications screen.
6. Tap to open the A/C settings menu.  
If the A/C menu is closed, the button area shows the current air vent mode.

The applications screen shows Multimedia, Phone, Video, Photo, Set up, and EasyConnection. These features can satisfy your demands in most scenarios during the use of your vehicle. We are continuously improving the system and will gradually introduce more useful applications.

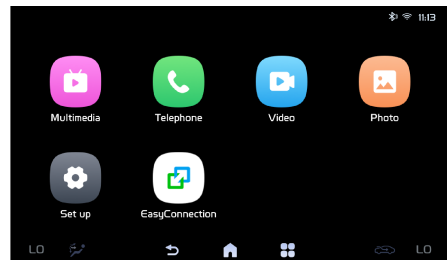

### Introduction to drop-down control centre

Swipe down from the top edge of the screen to open the control centre.

Press and hold any soft switch to enter edit mode. Then, you can add, remove, or rearrange soft switches.

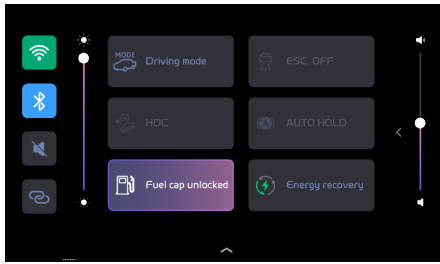

## Power On/Off and Restart

### Power on

When the system is turned off, you can turn it on using any of the following methods:

- Press the start switch once when the brake pedal is not depressed, and the start switch switches to the ACC position.
- Press the start switch twice when the brake pedal is not depressed, and the start switch switches to the ON position.
- Depress the brake pedal and press the start switch to start the vehicle.

### Power off

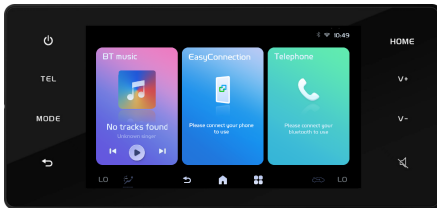

Press and hold the button  on the left side of the screen. After approx. 3 seconds, the display will turn off. Tap again to turn it back on.

### Restart

Press and hold the button  on the left side of the screen. After approx. 10 seconds, the system will restart.

## Vehicle setup

### Set up

Tap Set up to enter the vehicle setup screen.

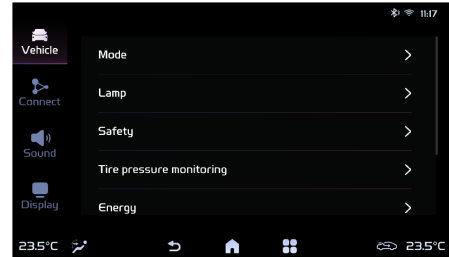

The screen contains four options: Vehicle, Connect, Sound and Display, covering common vehicle and system settings as well as safety and security settings, which can provide you with a better driving experience.

### Vehicle

Tap Set up  Vehicle.

You can configure the functions Mode, Lamp, Safety, Tire pressure monitoring, Energy and System.

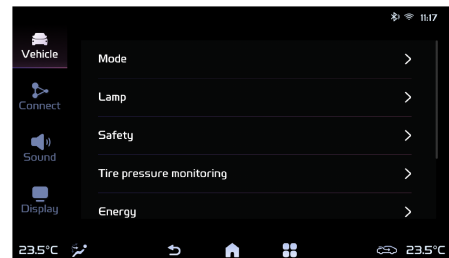

## Multimedia system (Type 2)

### Mode

Tap Set up → Vehicle → Mode.

You can select a driving mode from ECO, COMFORT, SPORT, MUD, SNOW, OFFROAD, and SAND (if equipped).

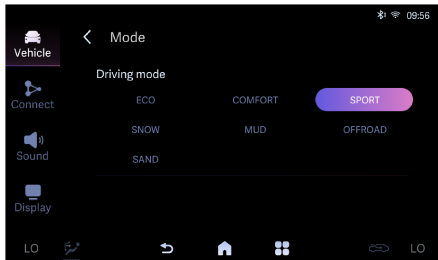

### Lamp

Tap Set up → Vehicle → Lamp.

You can configure Duration for follow me home lamp on and Cargo box lighting switch.

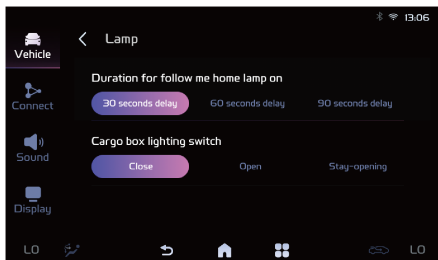

### Safety

Tap Set up → Vehicle → Safety.

You can configure the functions such as Alert type, Infotainment limitation during driving, Automatically close windows when car is locked, HDC, ESC OFF, AUTO HOLD, and Energy Recovery.

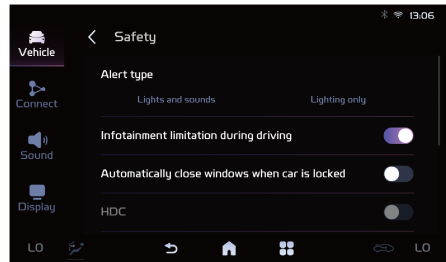

### Tyre pressure monitoring

Tap Set up → Vehicle → Tyre pressure monitoring.

You can calibrate the tyre pressure monitoring system.

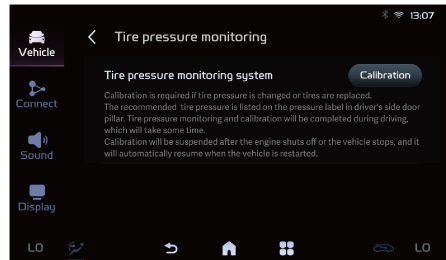

### Energy

Tap Set up → Vehicle → Energy.

You can configure the functions Charge, Discharge, Fuel range or Pure electric range, Fuel-based charging, and Driving power protection.

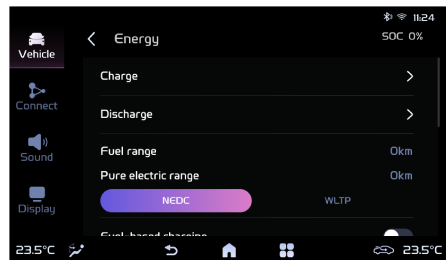



## System

Tap Set up → Vehicle → System.

You can view the version information of in-vehicle infotainment (IVI) system, restore the system to factory settings or perform a system upgrade, and select a language for the system.

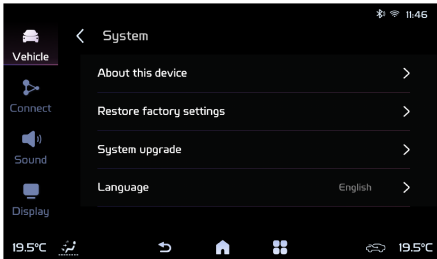

## Connect

Tap Set up → Connect.

You can configure Bluetooth devices, Wi-Fi direct and Wi-Fi hotspot of in-vehicle infotainment (IVI) system.

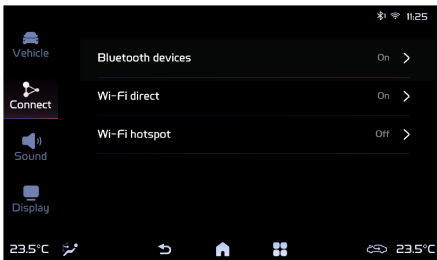

## Sound

Tap Set up → Sound.

You can set sounds for the entire vehicle.

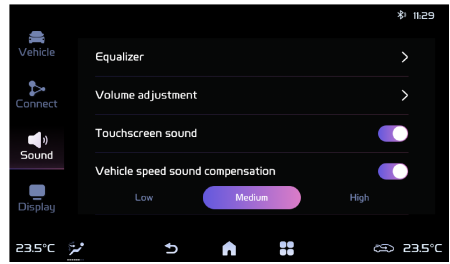

**Equalizer:** You can configure in-car audio equalizer effects.

**Volume adjustment:** You can set volumes for multimedia, phone calls, system alerts, and safety prompts.

**Touch sound:** You can turn on/off Touch sound.

**Vehicle speed sound compensation:** You can turn on or off Vehicle speed sound compensation, and select a preferred compensation level.

## Display

Tap Set up → Display.

You can configure Screen brightness adjustment and Clock display.

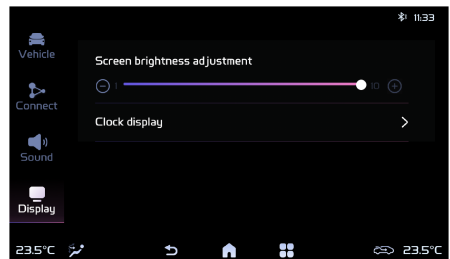

# Multimedia

## Introduction

Multimedia includes Radio, USB music, and BT music. It can provide you with an enhanced in-vehicle entertainment experience.

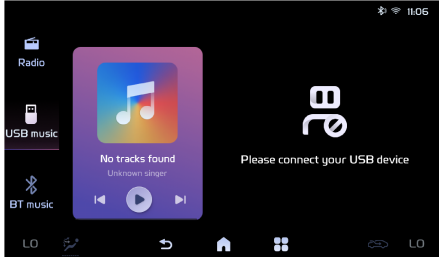

## Radio

Tap Multimedia → Radio.

You can select your desired radio channel for playback.

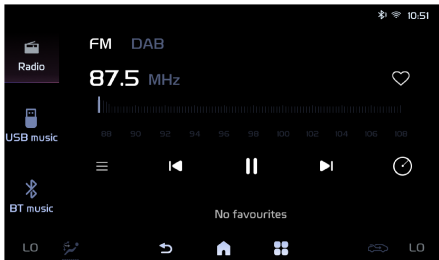

## USB music

Tap Multimedia → USB music.

You can select and play music from your USB device as desired.

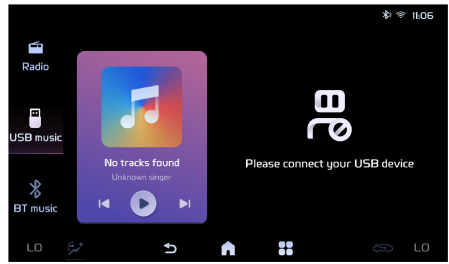

## BT music

Tap Multimedia → BT music.

Once Bluetooth is connected, you can play music from your paired device.

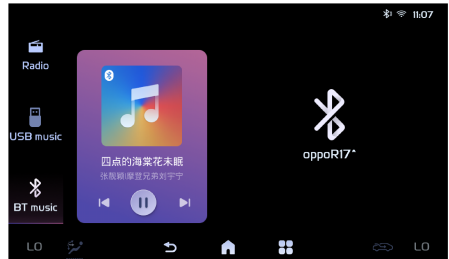

## Phone

### Making calls

Multiple ways to make calls are offered.

1. Dial. Enter the number you want to call in the phone number field of dial pad.



2. Contacts. Select a number from Contacts.

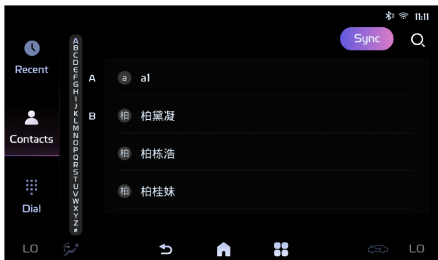

3. Recent. Select a number from Recent Calls.

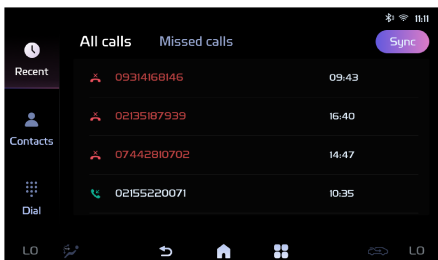

### Answering and ending calls

You can answer and end calls via the dedicated buttons on the steering wheel, or using the touchscreen.

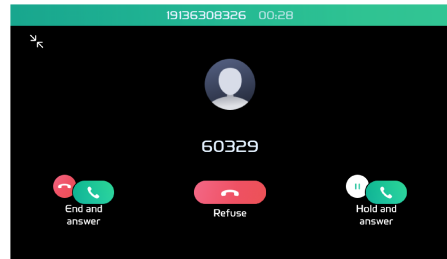

3

### Video and Photo

#### Video

Connect a USB device containing video files, and select desired videos for playback.



During video playback, you can adjust brightness or volume, and fast forward/rewind the video using swipe gestures shown here.

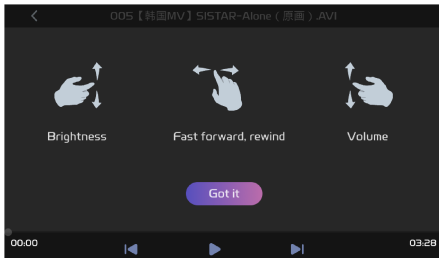

Tap Edit. Then, you can delete videos in the USB device individually or in batches.



#### Photo

Connect a USB device containing photos, and view selected photos.

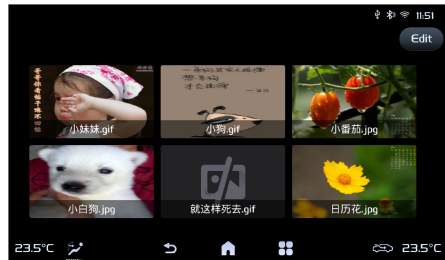

Tap Edit. Then, you can delete videos in the USB device individually or in batches.

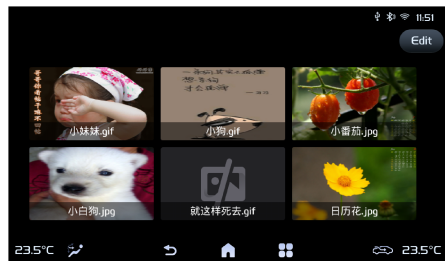

## EasyConnection

### EasyConnection

Tap the icon of the EasyConnection app.

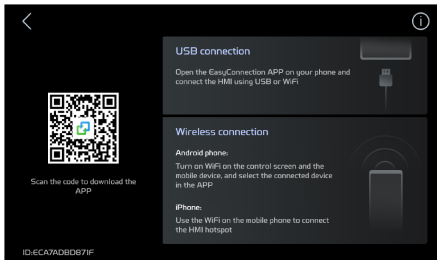

## Rear view camera (RVC)

### Introduction



Engage the R gear to enter the RVC screen.

- Reversing guidelines  
The reversing guidelines include dynamic trajectory lines. Please check the surroundings and ensure safety while reversing.
- Audio in reverse mode  
After entering reverse mode, the screen switches to rearview display, but Bluetooth call audio remains unaffected.
- Buttons, touchscreen, etc. in reverse mode:
  - During a call, the volume keys on the steering wheel remain functional.
  - The touchscreen is disabled.
  - Pop-up windows are disabled.
- Incoming call in reverse mode  
During reversing, if a call comes in or an ongoing call is interrupted by the reversing signal, the system will maintain the call audio output (without switching to the phone). Call answering, rejecting, or hanging

up must be done either on the phone or via the steering wheel's phone control buttons.